

THE BETA BEAT

SIGMA ALPHA EPSILON • UNIVERSITY OF MONTANA

Campaign for
MONTANA BETA
Preserving a Lifetime of
Brotherhood

SUMMER 2010

MONTANA BETA TO RECEIVE \$50,000 DONATION ONCE CAMPAIGN REACHES \$550,000

Do Not Miss This Exciting Opportunity, Send Your Gift Today



During phase one, the chapter house entryway received new paint, furniture, and polishing.

\$50,000 GIFT IS WITHIN OUR GRASP

Montana Beta has been presented with an exciting and advantageous opportunity. A generous alumnus has promised a donation of \$50,000, contingent upon Montana Beta reaching \$550,000 in written commitments. At the time of publication, we are \$12,924 short and need your help to ensure we meet this goal.

To refresh your memory, the proceeds from our campaign will retire the debt incurred from the renovation, create a capital improvement fund to provide for future maintenance, and provide a fire suppression system, a new kitchen, and a scholarship fund to help recruit new members and retain existing members.

Normally, fraternities wait until they have raised funds before embarking on a major renovation like ours. However, the Montana Beta campaign committee felt immediate improvement was necessary, as little renovating had been done over the years. We went ahead with construction and now the chapter house is something we can all be proud of.

MORE ALUMNI VOLUNTEERS/INVOLVEMENT NEEDED

We have worked with the undergraduates to build chapter membership and, frankly, it has been a struggle. We hired an organization that specializes in fraternity and sorority recruitment to help train the active chapter on how to attract quality members. In addition, four undergraduates are going to ΣAE Leadership School in August. Before the fall semester begins, the undergraduate membership and a number of alumni will attend a two-day retreat to plan for next year. We can always use additional alumni involvement—for this retreat and for all events during the year.

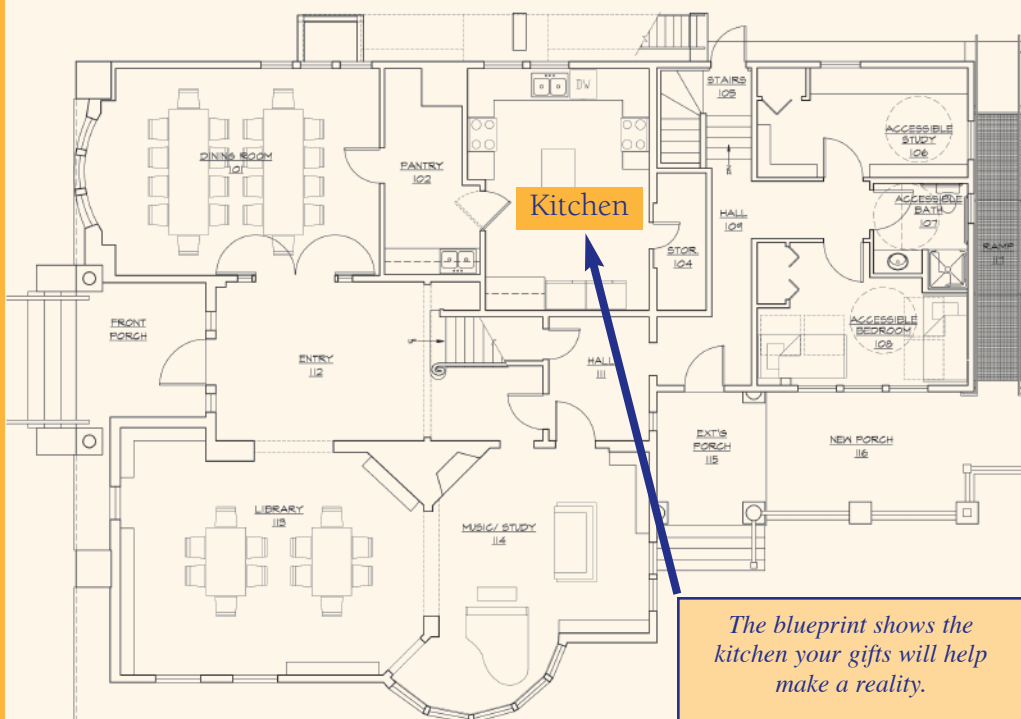

The blueprint shows the kitchen your gifts will help make a reality.

We believe a direct approach is the best approach. Clearly put, **we need your help**. Any amount you are comfortable giving will be gladly accepted. And now is the perfect time to donate, as it will put us that much closer to receiving the \$50,000 donation. A one-time gift is helpful, but a pledge spanning five years is even better and easy to budget through scheduled pledge payments. However, if you want to write a check for \$10,000, \$25,000 or half a million, please do!

While we need your help to reach \$550,000, our big picture goal is to reach \$1 million. We need every alumnus to come together and contribute to the campaign. This requires support from our entire chapter. Please mail your enclosed pledge card today. If you prefer to donate online, go to our web site, www.umsae.net, and click on the donate button. The transaction will be handled by PayPal. All we ask is that you contribute as a way of showing your pride of our great Fraternity. If you have questions please contact us.

In the Bonds,
Dick Ford '64
(925) 933-4940 | richard_ford@sbcglobal.net

Tony Wertz '65
(530) 848-3657 | tony_wertz@msn.com

CAMPAIGN FOR MONTANA BETA:
PRESERVING A LIFETIME OF BROTHERHOOD

THANK YOU, LOYAL BROTHERS AND FRIENDS,
FOR COMMITTING \$537,076

We are deeply grateful to the following brothers for committing \$537,076 to the *Campaign for Montana Beta: Preserving a Lifetime of Brotherhood*. These alumni recognize the importance of ensuring the future of Montana Beta and have demonstrated a sense of gratitude for their personal experience. Commitments are still needed from the rest of our alumni to achieve our goal of \$1 million to complete renovations.

Archon Society
(\$100,000 and more)
Jim R. Mountain '81

Minerva Society
(\$50,000 to \$99,999)
Lawrence A. Wertz '65
Donald C. Cowles III '66

Phoenix Society
(\$25,000 to \$49,999)
Lyle M. Glascock '62
John L. Olson '62
In memory of
Earl Bouse '64 and
John Hughes
In honor of
Dick Ford '64
Dick Ford '64
Brent D. Beckley '03

Phi Alpha Society
(\$10,000 to \$24,999)
W. Stan Halverson '41
George D. Caras '46
John W. Northey '62
Thomas P. Ross '62
Col USAF/RET
Kenneth R. Lawrence '63
David K. Voight '63

Dennis L. Stevens '64
James A. Willits '64
In honor of
Dick Ford '64
Robert B. Clark '66
Robert S. Jackson '68
John D. Streich '83
Thomas B. Wenz '98

Alumni Circle
(\$5,000 to \$9,999)
Richard J. Barney '58
Rex K. Lincoln '60
Kenneth C. Mlekush '60
William J. Beecher '63
William L. Bouchee '63
Wyley P. Good '63
James Tecca '65
Ronald D. Cole '81
Scott D. Johnson '81
Scott Thompson '83
David A. Bell '96
Peter Barovich '00

Active Member Circle
(\$1,000 to \$4,999)
Warren Wilcox
James H. LaRue '42
Gregory H. Wallander '56
John O. Ferro '58
David H. Nelson '58

All donors contributing a minimum of \$2,500 to the campaign, over a five-year period, will be recognized on a plaque prominently displayed in the chapter house. If an error has been made in recording your gift, or your name has been mistakenly omitted or listed improperly, we sincerely apologize. Please send corrections to **Dick Ford '64** at Montana Beta Chapter of Sigma Alpha Epsilon, P.O. Box 3343, Missoula, MT 59806.

Gerry Livesey '59
Robert P. Carlberg '62
Wayne A. Hinrichs '62
David G. Shultz '62
Ed Hale '63
David A. Graham '64
H. Thomas Lehrkind '64
John D. Bailey '65
Robert T. Haynam Jr. '65
John R. Greener '79
In honor of
Gail D. Greener '79
Bill Griffiths '80
In memory of
Kevin Larson
Timothy Borchers '84
In honor of
George Borchers '29
Jacob Byrne '10
MacKennon Klink '10
Cody Knowlten '10
Alex Segal '10
Alex Anderson '11
Benjamin Jensen '11
Nicholas Tarter '12

True Gentlemen Society
(Up to \$999)
Zane G. Murfitt '50
Jack LeClaire '52
Park Densmore '53

CAMPAIGN STATUS
AT-A-GLANCE

As of June 21, 2010

\$1 Million Goal

746 Mailable Alumni

64 Contributors

\$537,076 Total Contributions

Donald O. Enebo '54
Skulason Moe '54
Charles W. Bloom '57
Howard Ness '57
Larry C. Eichhorn '61
Stephen L. Johnson '63
COL USA/RET Michael C. Baker '64
Gregory L. Ulmer '66
Rodger D. Young '68
Dennis LaBonty '71
Tom Barnett '79
In memory of
Tom Bird
Edward Fisher '82

John L. Olson '62 Donates to Capital Campaign
to Ensure Survival of Montana Beta



Joining the brotherhood of ΣAE was one of the most important decisions **John L. Olson '62** ever made. "It has challenged me to excel to higher goals and continues to remind me to experience things through the eyes of others, seeing where they came from."

Working in the Montana Beta general store and performing the duties of song leader taught John the basics of running a business and important principles of leadership. "These experiences have paid huge dividends as I pursued a career

in business based on solid work ethics and family principles."

John donated to the campaign for Montana Beta to "ensure the survival of our wonderful fraternity," and believes he owes a large debt of gratitude to Montana Beta and ΣAE. Today, John is president and CEO of the Blue Rock Companies, a franchise Pepsi-Cola bottler and Miller, Coors and Gallo wine distributor in eastern Montana and western North Dakota. He is a past chairman of the National Pepsi-Cola Bottlers Association and is a retired corporate

director for MDU Resources Group and Blue Cross Blue Shield of Montana.

John serves as board chairman of Admiral Beverage Corporation of Worland, Wyoming, Ogden, Utah, Anchorage, Alaska and Albuquerque, New Mexico. A former chairman of the University of Montana Foundation, he and his wife, Marilyn, received UM's Distinguished Community Service Award in 2006. They were also the honorary chairmen of the C. M. Russell auction in 2004. John will complete his service on the National Advisory Board for Grizzly Athletics this year.

"If we hadn't been ΣAEs it would have altered the course of our lives and changed the men we became. We have a responsibility to ensure that future generations have similar opportunities." - David Bell '96

MONTANA BETA BROTHER TRAVELS WORLD BUT RETURNS TO ΣAE ROOTS

Why I Gave—David Bell '96

David Bell '96 grew up in Florida, Kentucky, and Pennsylvania but had never traveled to Montana until he began his freshman year of college. He left campus his junior year to travel around the world on Semester at Sea, an educational ship, and then worked for the United States Senate in Washington, D.C. He continued his travels by living in Costa Rica, participating in a language immersion program. David returned to Missoula for his senior year, where he met Brittany Gustafson, now his wife of 12 years.

After David graduated from UM, he joined The Chubb Corporation, a global insurance company based in Florida. In the aftermath of 9/11, the U.S. insurance marketplace was destabilized tremendously. Chubb, AIG, and Goldman Sachs started a joint-venture insurance company based in Bermuda to create new insurance capacity. In 2002, David was asked to move to Bermuda with three others to start up Allied World Assurance Company (AW). In 2006 they took the company public on the NYSE. Currently, AW has 15 offices in six countries and nearly \$10 billion in total assets.

An established leader in the insurance industry, David was elected president of the Professional Liability Underwriting Society (PLUS), whose 6,000 members comprise the largest insurance industry association focused on education. Never feeling far from Montana, however, David recently secured a \$450,000 grant from PLUS to start a college of insurance emphasis at UM.



David says the accomplishment he is most proud of is the founding of Grateful Nation Montana (GNM). GNM provides college educations for children of Montana soldiers killed in active duty in Iraq or Afghanistan. It is a first-of-its-kind program that targets not only the financial but also educational and emotional needs of these children. David worked with UM President George Dennison and the Montana state university system to develop a comprehensive outreach program. Participating colleges and universities provide tutoring and mentoring to eligible students during their high school years, so they are academically and emotionally prepared to succeed in college and beyond. GNM, called a "revolutionary" public/private partnership, has been featured on NBC Nightly News with Brian Williams, on Fox & Friends, and on National Public Radio.

David travels to Montana regularly for Grateful Nation, as well as for other organization boards he serves on within the state. Recently, he connected with **Dick Ford '64** and was impressed with his and

other brothers' commitment to revitalize the finances and physical structure of Montana Beta on Gerald Avenue. "We had some great experiences in that house. It helped shape who we are. If we hadn't been ΣAEs it would have altered the course of our lives and changed the men we became. We have a responsibility to ensure that future generations have similar opportunities," David said.

David and Brittany live in Bermuda with their two children, Trent (6) and Ivy (4). Contact him at david.bell@awac.com.



Montana Beta's White Motor Company touring bus was purchased from Yellowstone National Park. Exterior paintings on the bus were done by artist Doug Baldwin '61.

As some of you know, Montana Beta once had a vintage Yellowstone park bus called Minerva. For those not familiar with Minerva, it was a bus similar to those used throughout Glacier National Park and in Yellowstone. During the 1970s or late 1960s, Minerva was sold. I assume the reason had to do with upkeep expenses and liability.

Minerva was a real chick magnet. The brothers would load up on Friday or Saturday after pledge duties, drive fraternity and sorority row, and load up as many coeds as possible. Sometimes we were delayed because our Sigma Chi neighbors would sneak over during the night and drop the driveshaft.

HOUSE CORPORATION MEMBERS TRACE HISTORY OF CHICK MAGNET MINERVA

Call If You Have Information on the Montana Beta Bus

They usually were kind enough to leave all the parts on the ground under the bus, so it was just a matter of hooking it up again and off we'd go.

Some of the history of Minerva is lost to me, so I am asking anyone who knows the answers to these questions to give me a call.

When did we buy Minerva and how much did she cost?

When did we sell Minerva and for how much?

If you know the answer to either question, please give me a call at (925) 933-4940 or e-mail me at richard_ford@sbcglobal.net.

If you have any pictures of Minerva, we would love to obtain a copy for the ΣAE archives. I hope I will have the answers by the next *Beta Beat*.

Phi Alpha,
Dick Ford '64

Chapter Focuses on Community Service, Recruitment Strategies

Montana Beta Represents at Σ AE
Leadership Conference

It was a busy spring semester for the brothers of Montana Beta. Our involvement with a number of philanthropic events kept us hopping all spring. We participated with the Big Brothers Big Sisters Bowl-a-Thon, also known as Bowl for Kids' Sake, and helped clean up after the event. The brotherhood helped with the Missoula Hospice Ball cleanup and several worked the night of the ball as waiters. In late April, we had a polar bear swim in the Clark Fork River to raise money for Σ AE Special Olympics, sold t-shirts to raise money for the event, and participated in the American Cancer Society Relay for Life.

BROTHERS ATTEND Σ AE LEADERSHIP CONFERENCE

Jason Newton '10, Cody Knowlton '10, Josh Treynor '11, and Nick Tarter '10 will attend the 75th Σ AE Leadership School in August. This is our largest representation in several years. The event will be held on a cruise ship sailing out of Miami. The brothers are excited to learn a lot and bring back new knowledge to share with their brothers.

MEMBERS RECEIVE RECRUITMENT TRAINING

We are excited to have fraternity recruiting firm Phired Up helping us with our fall recruitment efforts. They will provide additional training on what it takes to attract top-notch new members. If someone you know is headed to the University of Montana and you think he would make an excellent Σ AE, please let us know and fill out the recruitment recommendation form on this page.

I hope to see you at Homecoming on September 25. Be sure to stop by the house and see the wonderful changes taking place at 1120 Gerald Avenue.

In the Bonds,
Jason Newton '10
Eminent Archon
jason.newton@umontana.edu

WEB SITES

Montana Beta Chapter

www.umsae.net

Σ AE National

www.sae.net

University of Montana

www.umt.edu



MONTANA BETA CHAPTER OF
SIGMA ALPHA EPSILON

P.O. BOX 3343
MISSOULA, MT 59806

ADDRESS SERVICE REQUESTED

PRSR
FIRST CLASS
U.S. POSTAGE
PAID
LAWRENCE, KS
PERMIT #570

Attention:

This newsletter is intended for alumni and parents. If your son is still attending the University of Montana, he will receive a copy at the chapter house. If he has graduated, please send us his permanent address to update our records. Thank you.

Alumni, Recommend a Man for Recruitment

Prospect's Name _____

Home Address _____

City _____ State _____ Zip _____

Phone _____ E-mail _____

Does prospect have an Σ AE relative? _____

Reference submitted by _____

Phone _____ E-mail _____

Alumni, we value your referrals. If you know of good men on campus who have not joined a fraternity or high school seniors headed to Missoula, please recommend and impress upon them the values of Sigma Alpha Epsilon. You may submit prospect recommendations to **Jason Newton '10** at Montana Beta Chapter of Sigma Alpha Epsilon, P.O. Box 3343, Missoula, MT 59806.